

FLOORPLAN VILLA RISSEN HAMBURG



VILLA RISSEN
HAMBURG







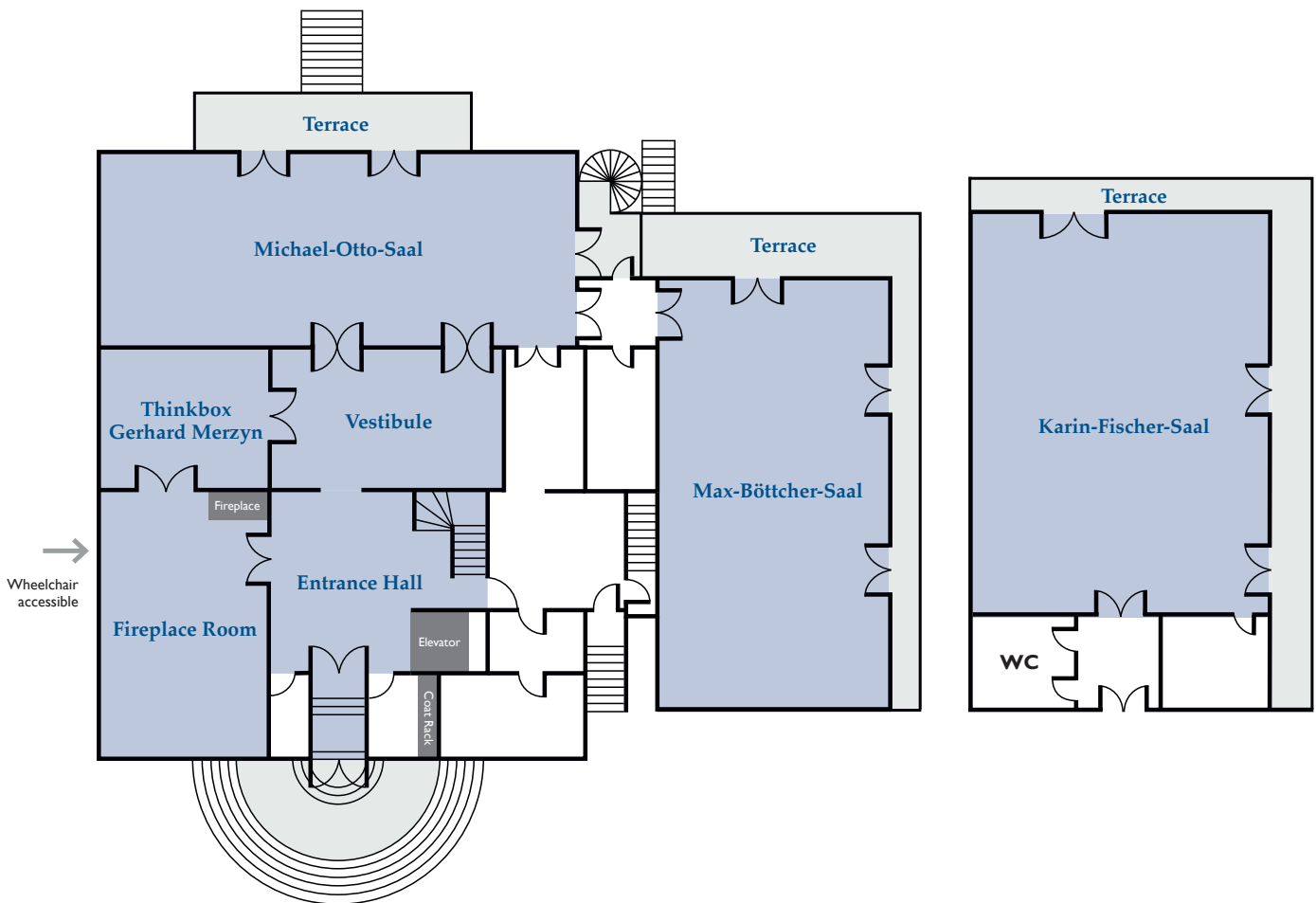

Floorplan

Ground Floor



Room Size **Height** **Seating**

									
			Class	Conference	U-Shape	Circle	Reception	Banquet	Theatre
Entrance Hall	33 sqm	2,80 m	-	-	-	-	20	-	-
Vestibule	33 sqm	2,80 m	-	-	-	-	20	16	-
Thinkbox GM	29 sqm	2,80 m	12	16	-	20	20	16	24
Fireplace Room	55 sqm	2,80 m	24	20	20	24	40	24	50
Max-Böttcher-Saal	99 sqm	2,80 m	40	32	20	40	60	64	80
Karin-Fischer-Saal	122 sqm	3,20 m	46	32	28	40	80	72	135
Michael-Otto-Saal	120 sqm	2,60 m	56	50	46	50	100	80	180



Floorplan



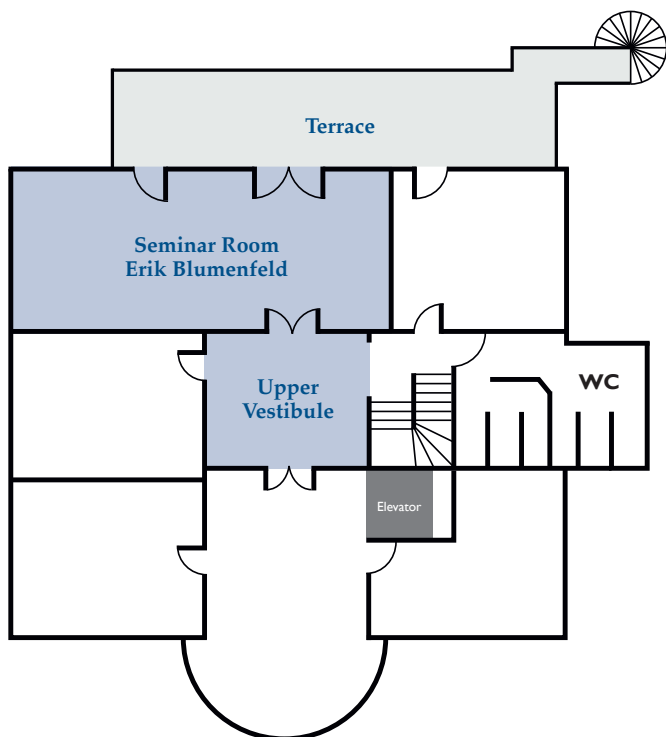

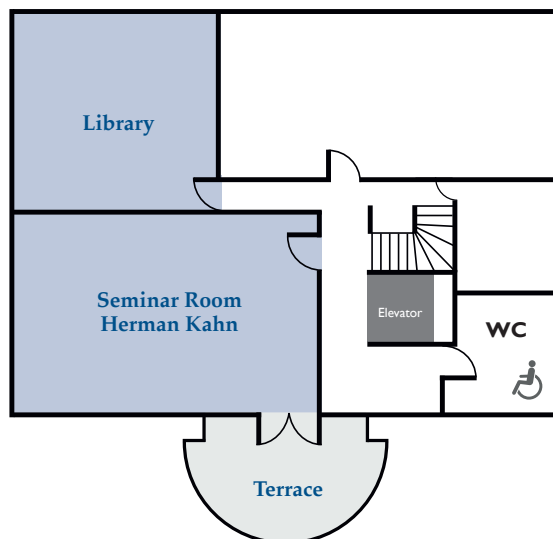

First Floor



Top Floor



Room Size Hight Seating

								
			Class	Conference	U-Shape	Circle	Banquet	Theatre
Seminar Room Erik Blumenfeld	53 sqm	3,00 m	20	18	22	20	18	40
Library	27 sqm	3,50 m	-	8	-	8	-	-
Seminar Room Herman Kahn	54 sqm	3,50 m	24	20	18	22	-	30



VILLA RISSEN
HAMBURG